



Assa Abloy - Authoring Guide

Component - Icon Group

Version #	Contributor	Date	Description	Reviewed By
0.1	Mayank Jain	30 Sep 2021	Initial version	
1.0	Manish Gupta	03 Jan 2022	Reviewed and updated	

Table of Contents

1 Overview	4
2 Business Use Case	4
3 Design	Error! Bookmark not defined.
4 Authoring Steps	4
5 User Interface	9

Component: Icon Group

1 Overview

An icon group is group of icons which presents on a website to navigate to various links/pages and displays important information. This component have capability to provide authoring and display of one or more icons. It can be used on various pages. It is usually appears as part of Header component

It can have below information for each of the icon:

- Options
- Icon image
- Icon Alt text
- Label
- Icon Target URL
- Target

2 Business Use Case

Designing of Icon group component for ASSA America Site Pages

3 Authoring Steps

- **Step 1:** Create a new page or open an existing page by selecting the page and click on Edit option.

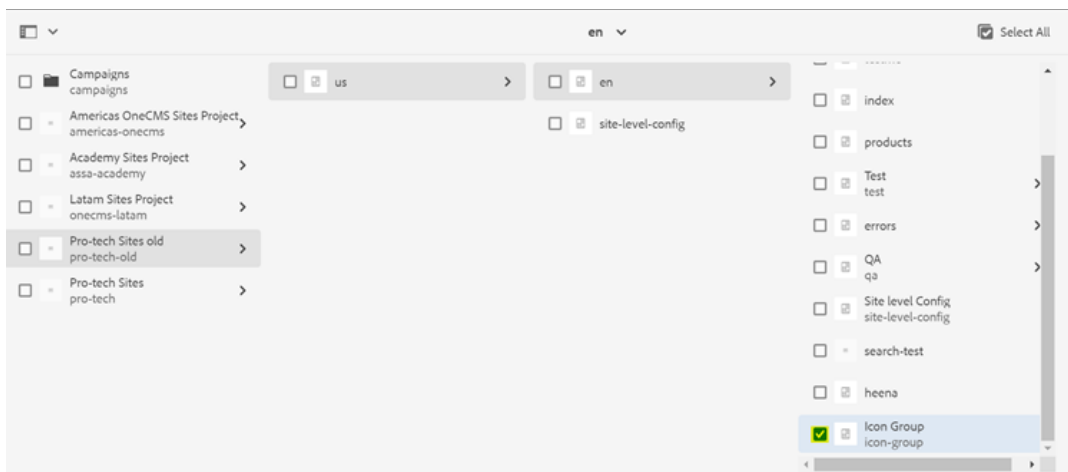

- **Step 2:** Once the Page is opened, insert the Icon group component into the page. It can be achieved via either of following ways
 - Go to the content panel from the top left side panel and then click on the component tab and Drag the icon group component from the left side panel and drop it inside the Layout Container.

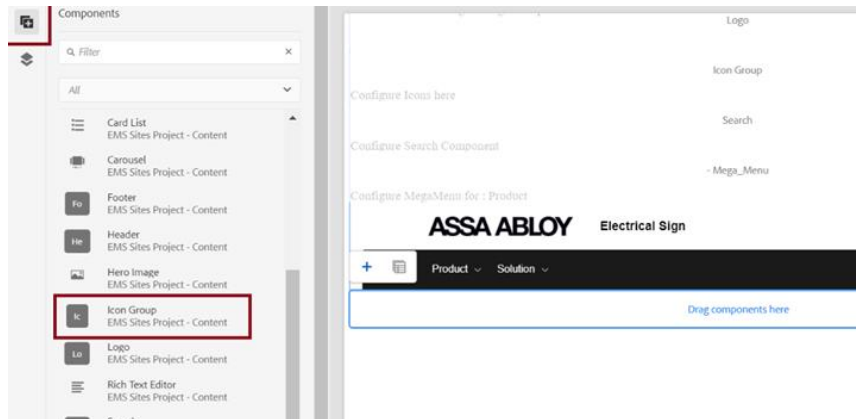

- Double click on the placeholder which is denoted by “Drag Components here”, or click on the plus icon available on the placeholder and choose Icon group from the provided list of components

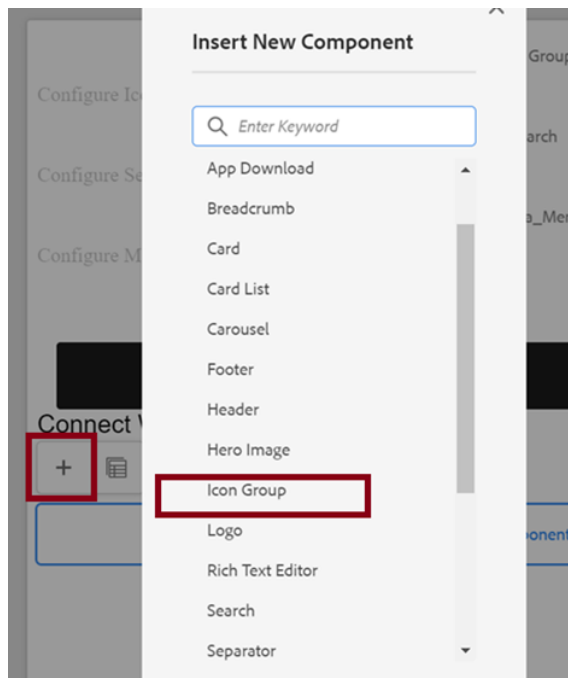

- **Step 3:** Now Select this component and click on the wrench icon to open the component dialog or double click on it.

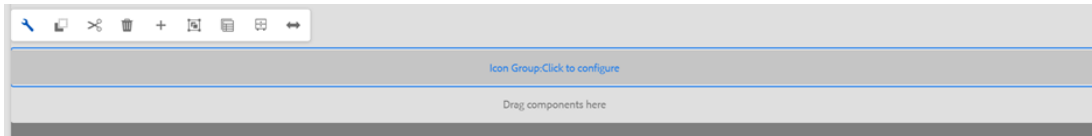

- **Step 4:** Enter the corresponding icon and label details as per below snapshot

A screenshot of the "Icon Group" configuration dialog. The dialog has a title bar with a question mark and a close icon. Below the title bar, there is a section titled "Action Icons". Inside this section, there is a sub-section titled "Expand/Collapse Icon details" with a trash icon. This sub-section contains several fields: "Options" (a dropdown menu with "Navlink as text" selected), "Icon Alt text" (a text input field), "Label" (a text input field), "Icon Target URL" (a text input field with a folder icon), and "Target" (a dropdown menu with "Self" selected). At the bottom of the sub-section is an "Add" button. At the bottom of the dialog are "Cancel" and "Done" buttons.

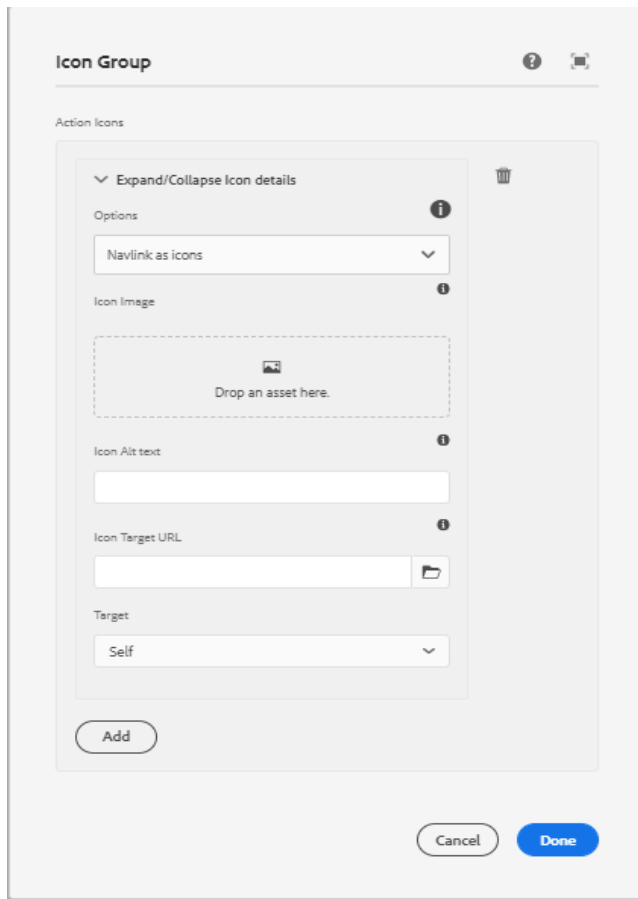

➤ Step 5: Fill in all the required details in the dialog as following table.

S. No	Field Title	Field Type	Field Description	Mandatory (Yes/No)	Validation/Remarks (If any)
1.	Options	Dropdown	Enter the Icons details	Yes	Select Navlink as icons or Navlink as text
1.1	Navlink as Icons	Option in Dropdown	To display the icon	No	
a.	Icon Image	Image (Drag & Drop)	Browse the Icon image from DAM	No	
b.	Icon Alt Text	Text Field	Alt text to display on Icon	Yes	
c.	Icon Target URL	Path Field	Enter/Browse the Link /URL of Icon	No	

d.	Target	Select Field	Select the Icon URL Target Options: <ul style="list-style-type: none"> Self (Open in Same Window) Blank (Open in New Window)	NA Default - Open in Same Window	
1.2	Navlink as text	Option in Dropdown	To display the text	No	
a.	Icon Alt Text	Text Field	Alt text to display on Icon	Yes	
b.	Label	Text Field	Label to Display on Icon	No	
c.	Icon Target URL	Path Field	Enter/Browse the Link /URL of Icon	No	
d.	Target	Select Field	Select the label URL Target Options: <ul style="list-style-type: none"> Self (Open in Same Window) Blank (Open in New Window)	NA Default - Open in Same Window	

- Step 6: Click “Done” once you have entered all these details
- Step 7: The authored icons will now be visible on the Page as an icon-group and can be viewed.

4 User Interface

Sample Input Snapshot

Please refer below a sample dialog for input

Here, Navlinks as icons option is selected in Option field.

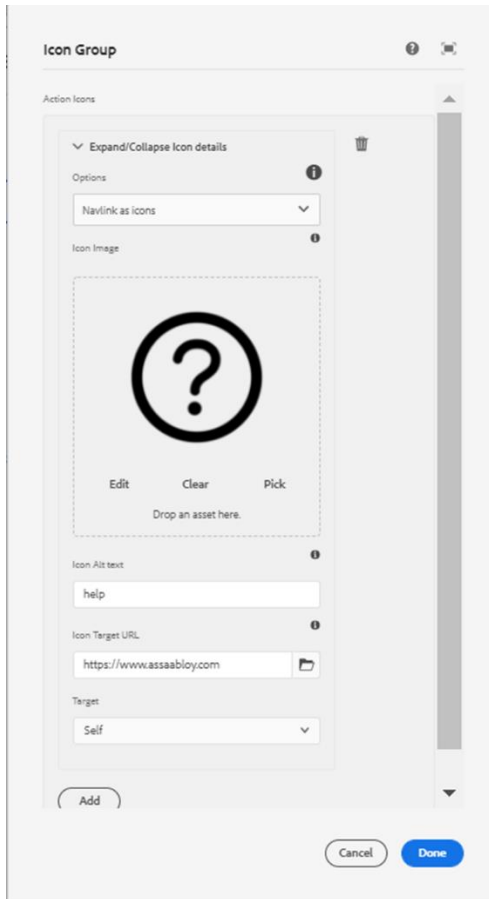

Sample Output:



Sample Input Snapshot:

Please refer below a sample dialog for input

Here, Navlinks as text option is selected in Option field

The screenshot shows a configuration window titled "Icon Group". Inside, there is a section for "Action Icons" with a sub-section "Expand/Collapse Icon details" that is expanded. This sub-section contains several input fields: "Options" is a dropdown menu with "Navlink as text" selected; "Icon Alt text" is a text input field containing "Contact"; "Label" is a text input field containing "Contact us"; "Icon Target URL" is a text input field containing "https://www.assaabloy.com" with a folder icon to its right; and "Target" is a dropdown menu with "Self" selected. There are information icons (i) next to the "Options", "Icon Alt text", "Label", and "Icon Target URL" fields. At the bottom of the dialog are three buttons: "Add", "Cancel", and "Done".

Sample Output:

