



# Assa Abloy - Authoring Guide

Component – Click To Content

<b>Version #</b>	<b>Contributor</b>	<b>Date</b>	<b>Description</b>	<b>Reviewed By</b>
1.0	Misal Singh	09 Feb 2022	Initial version	Rajen Upreti

## Table of Contents

1 Overview .....	4
2 Business Use Case .....	4
3 Design.....	4
4 Authoring Steps.....	4



# Component: Click to Content

## 1 Overview

Click to content works in parallel to the Tab Container component. Anything added in the Tab container displays as the tab name in the click to content component. Clicking in the click to content tabs, user will be redirected to that particular section defined by the tab container.

**It is advised to refer the authoring of tab container also to author the click to content component.**

## 2 Business Use Case

The Click to Content component is used to quickly get to the content on the page using tab containers. There will be a tab for each tab container and when we click on that tab it will redirect our focus to that particular tab container's data.

## 3 Design

This Click to Content component contains the General and Display design. CTC component includes combinations of below fields:

- Tab Alignment
- CTA Text
- CTA path
- CTA Theme
- Open in Different Tab?
- Component background color options

## 4 Authoring Steps

- **Step 1:** Create a new page or open an existing page by selecting the page and click on Edit option.

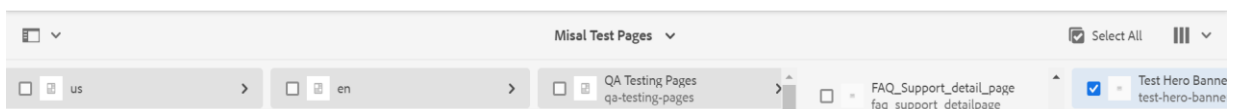

- **Step 2:** Once the Page is opened, go to the content panel from the top left side panel and then click on the component tab and Drag the Click to Content component from the left side panel and drop it inside the Layout Container.

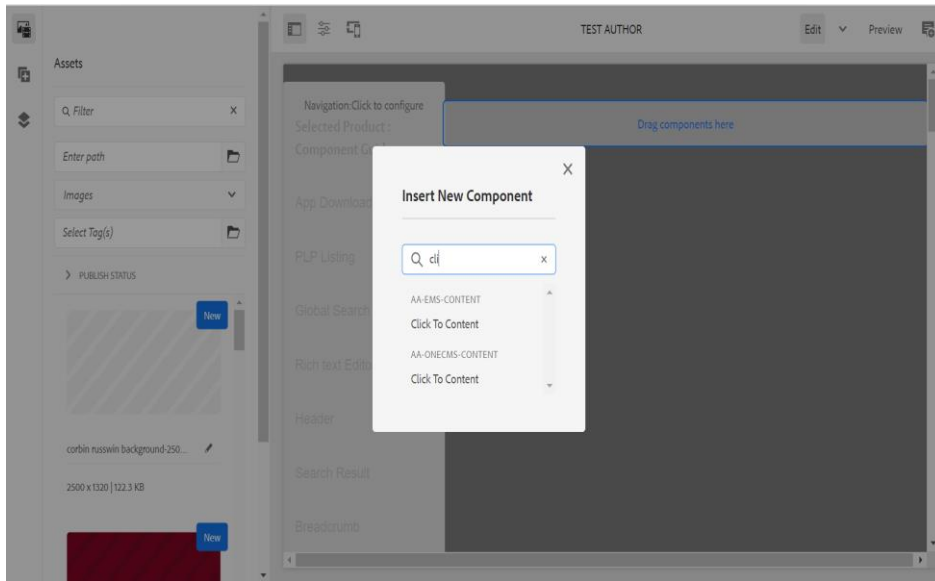

- **Step 3:** Select the Click to Content component and click on the wrench icon to open the component dialog.

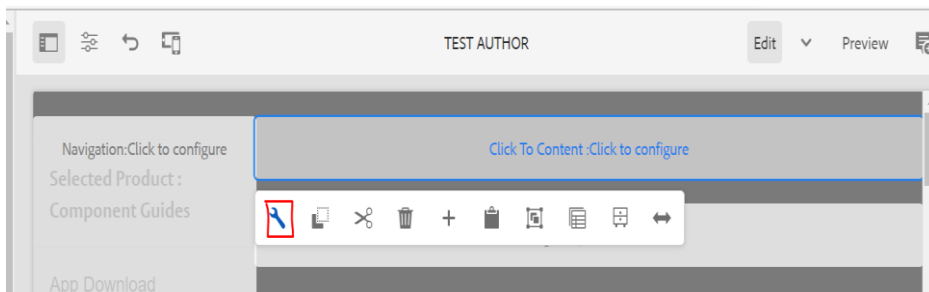

- **Step 4:** Enter the details in the General tab as shown below.

The screenshot shows the 'Click To Content' dialog box with the 'General' tab selected. The dialog has a title bar with a question mark and a close icon. Below the title bar are two tabs: 'General' and 'Display'. The 'General' tab contains the following fields:

- Tab Alignment:** A dropdown menu with 'Left' selected.
- CTA Text:** An empty text input field.
- CTA Path:** An empty text input field with a folder icon on the right.
- CTA Theme:** An empty dropdown menu.

At the bottom right of the dialog are two buttons: 'Cancel' and 'Done'.

➤ Step 5 Enter the details in the Display tab

The screenshot shows the 'Click To Content' dialog box with the 'Display' tab selected. The dialog has a title bar with a question mark and a close icon. Below the title bar are two tabs: 'General' and 'Display'. The 'Display' tab contains the following field:

- Component background color options:** A dropdown menu with 'Grey' selected.

At the bottom right of the dialog are two buttons: 'Cancel' and 'Done'.

➤ Step 6: Fill in all the required details in the component dialog as following table.

S. No	Field Title	Field Type	Field Description	Mandatory (Yes/No)
1.	Tab Alignment	Drop Down	Drop Down selection	No
2	CTA Text	Text Field	Enter Text	No
3	Title	Text Field	Enter the title.	No
4	CTA Theme	Drop Down	Drop Down selection	No
5	Open in Different Tab?	Drop Down	Drop Down selection	No
6	Component Background Color	Select (options)	Select Color options	No

- Step 7: Click “Done” once you have entered all these details.
- Step 8: The Click To Content will now be visible on the Page and can be previewed.

## 5 User Interface

