



# Assa Abloy - Authoring Guide

Component - Card

Version #	Contributor	Date	Description	Reviewed By
0.1	Mayank Jain	12 Oct 2021	Initial version	
1.0	Rajen Upreti	04 Jan 2022	Reviewed and Updated	

## Table of Contents

1 Overview .....	4
2 Business Use Case .....	4
3 Design .....	4
4 Authoring Steps .....	4
5 User Interface .....	9

# Component: Card

## 1 Overview

Card Component allows web authors to display Card icons.

## 2 Business Use Case

It is a way to display Card icons which takes the end user to corresponding link.

## 3 Design

The Card Component is a nested multifield component.

The Card component contains the authoring for Card Columns, Card Variant, Image AltText, Pre Title, Title, Description, CTA List (Multifield).

CTA List is a multifield which contains CTA Text, CTA Path, CTA Theme.

## 4 Authoring Steps

- Step 1: Create a new page or open an existing page by selecting the page and click on Edit option.

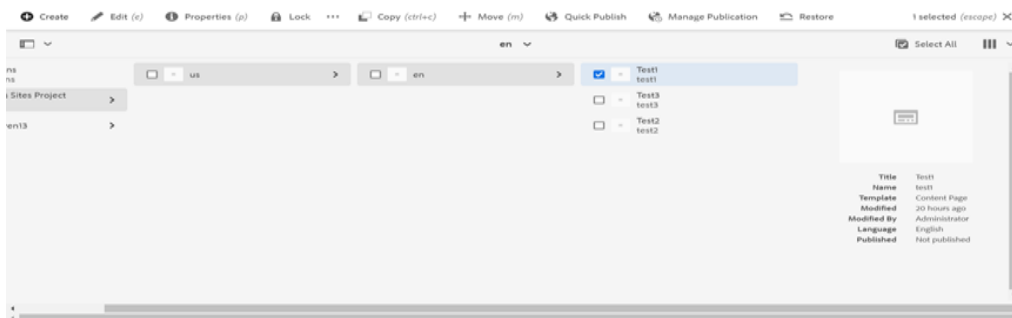

- **Step 2:** Once the Page is opened, go to the content panel from the top left side panel and then click on the component tab and Drag the Card Component from the left side panel and drop it inside the Layout Container. Or choose it from the available component list

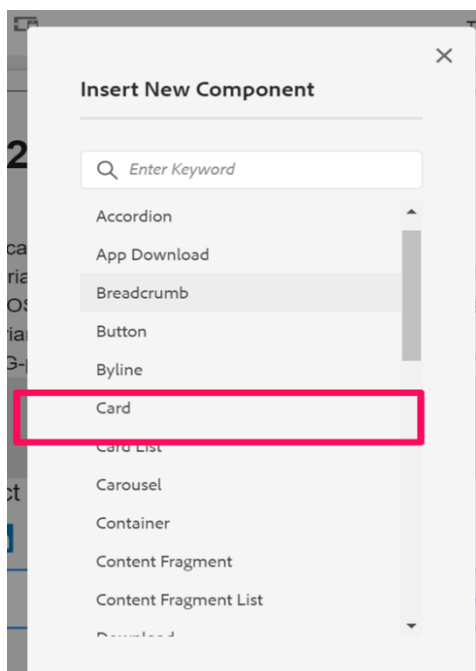
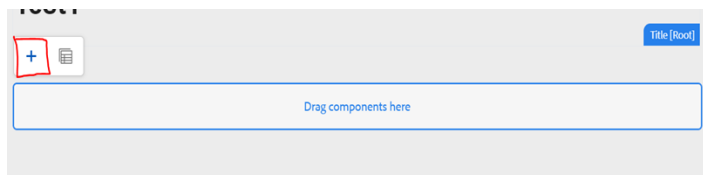
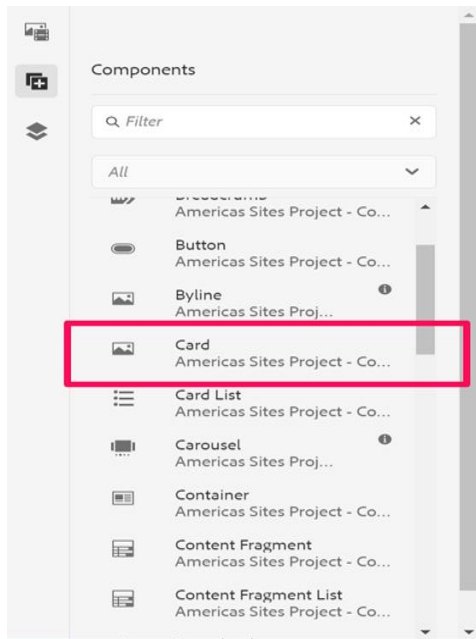

- **Step 3:** Select the Card component and click on the wrench icon to open the component dialog.

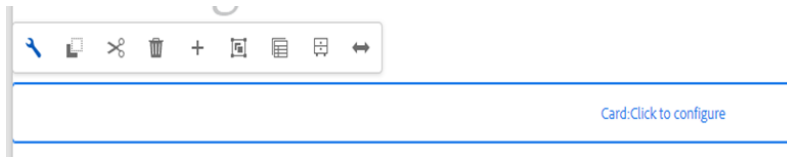

- **Step 4:** Enter the Card details in Card Dialog as per below snap

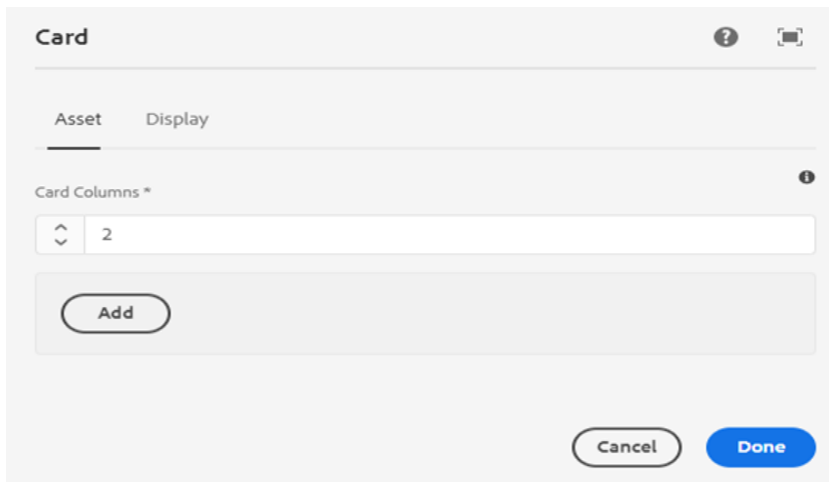

- **Step 5:** Click Add and expand to add and configure card icons.

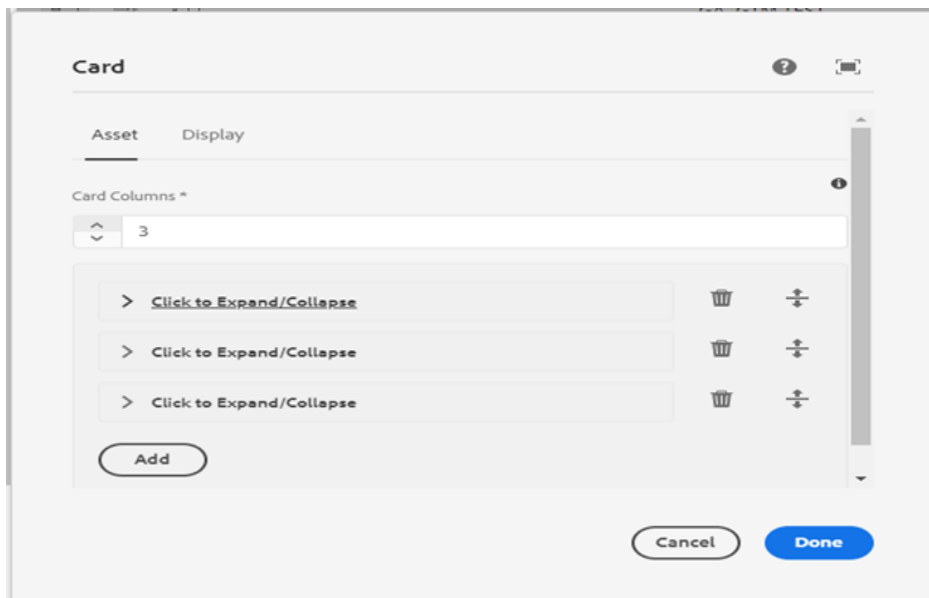

- Step 6: Enter the below fields to configure each card icon added.

**Card**

Asset    Display

Card Columns \*    2

Click to Expand/Collapse

Card Variant \*    Image as Background

Image

Drop an asset here.

Image Alt Text \*

Pre Title

Title \*

Description

CTA List

Add

Add

Cancel    Done

- **Step 7:** Click Add to the CTA list to add and configure the CTA items.

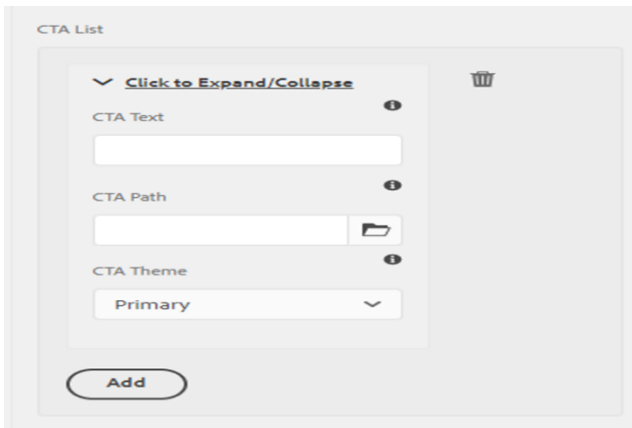

- Step 8:** Go to Display tab to add the require background color to the card( white/grey)

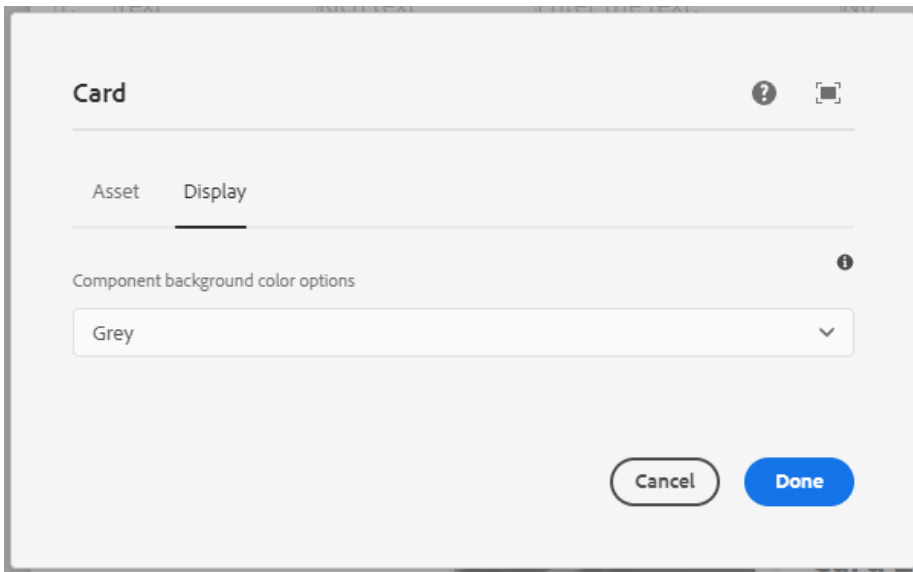



➤ Step 9: Fill in all the required details in the component dialog as following table

S. No	Field Title	Field Type	Field Description	Mandatory (Yes/No)
1	Card Columns	Number Field	The number of cards that will be visible in a single row.	Yes (Default - 2)
2	Card Details	Multifield		
2.1	Card Variant	Dropdown	Select the variant Select either "Text with Image", "Image as Background" or "Support Card for PLP" (product listing)	Yes
2.2	Image	Image upload	Choose Image for the slide	No
2.3	Image Alt text	Text Field	Alt text for Image	Yes
2.4	Pre Title	Text Field	Enter the Pre-Title (Works only with Card variant – Image as Background)	No
2.5	Title	Text Field	Enter the Title	Yes
2.6	Description	RTE	Enter the Description	No
2.7	CTA List	Multifield		
2.7.1	CTA Text	Text Field	Enter CTA Text for Button/Link	No
2.7.2	CTA Path	Browse	Enter CTA Path	No
2.7.3	CTA Theme	Dropdown	Select CTA Theme	No (Default - Primary)

➤ Step 10: Click “Done” once you have entered all these details. Fill in all the required details in the component dialog as following table

➤ Step 11: The Card will now be visible on the Page and can be previewed.

## 5 User Interface

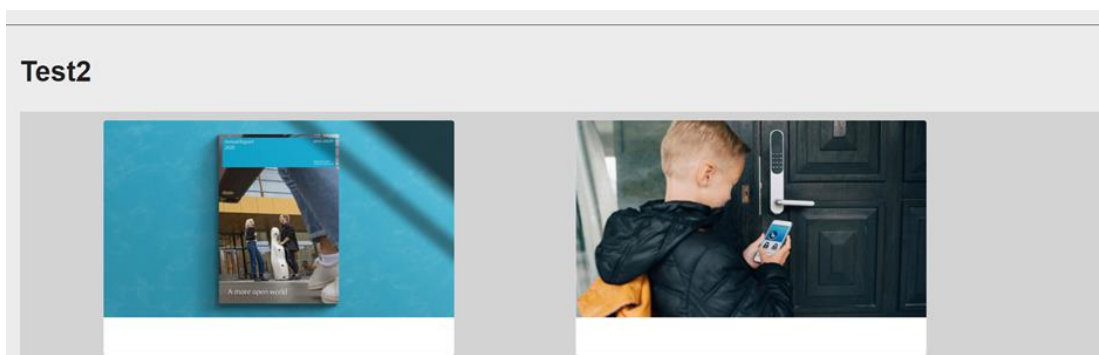

**Note:** When user hover on image, it will zoom out by default.